

YELLOWSTONE COUNTY BOARD OF COUNTY COMMISSIONERS
Resolution No. 24-27
Resolution to Expand Yellowstone County Rural Special Improvement District No. 689M
(Saddleback Ridge Estates)

WHEREAS, pursuant to Section 7-12-2161(4) of the Montana Code Annotated, a board of county commissioners can expand a rural special improvement once a year. The Montana Code Annotated does not specify the procedure a board should use to expand a district. When a property owner has not requested inclusion in a district, to ensure the property owner as an opportunity to explain to the board why the property should not be included in the district, a board should provide the property owner with notice of the board's intent to include the property in the district and an opportunity to explain to the board why the property should not be included in the district. The board should pass a resolution of intent to expand the district, set a public hearing on the resolution, provide notice of the public hearing to the owner of the property to be included in the district, hold a public hearing, receive comments on the inclusion of the property in the district and pass a resolution.

WHEREAS, the Yellowstone County Board of County Commissioners created Yellowstone County Rural Special Improvement District No. 689M to maintain roads in Saddleback Ridge Estates Subdivision.

WHEREAS, on January 23, 2024, the Yellowstone County Board of County Commissioners passed a resolution of intent to expand Yellowstone County Rural Special Improvement District No. 689M to maintain roads in Saddleback Ridge Estates Subdivision and set a public hearing on the expansion of the District for March 5, 2024. On January 26, 2024, the Yellowstone County Clerk and Recorder mailed notice of the hearing to all property owners in the proposed expansion of the District. On January 26, 2024 and February 2, 2024, the Yellowstone County Clerk and Recorder published notice of the public hearing in the *Yellowstone County News*. On March 5, 2024, the Board held a public hearing on the expansion of the District. The Board heard comments on the expansion of the District and considered protests as to the expansion of the District. The Board did not receive enough protests to prevent the expansion of the District. _____ out of 106 property owners protested the expansion of the District. The Board believes the expansion of the District is in the best interest of the public.

NOW THEREFORE, BE IT RESOLVED,

The Yellowstone County Board of County Commissioners expands Yellowstone County Rural Special Improvement District 689M to maintain roads in Saddleback Ridge Estates Subdivision. Attached as Exhibit A is a map showing the current boundary and the proposed expanded boundary. Attached as Exhibit B is a listing of current property owners and proposed property owners to be added to the District. The assessment for the District will appear on the property owners' 2024 tax statements.

Passed and Adopted on the 5th day of March 2024.

BOARD OF COUNTY COMMISSIONERS, YELLOWSTONE COUNTY, MONTANA

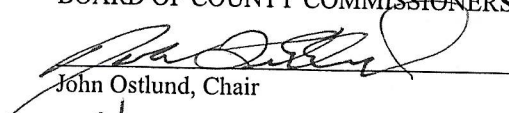

John Ostlund, Chair

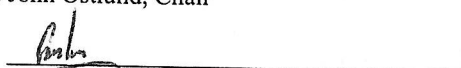

Mark Morse, Member

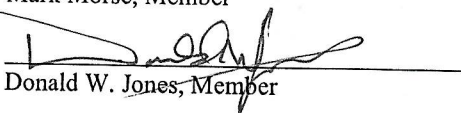

Donald W. Jones, Member

ATTEST:

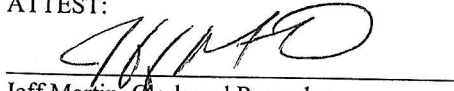

Jeff Martin, Clerk and Recorder

EXHIBIT A

RSID 689M

D02552

D02551

D02554

D02416

D12801

D12806

D12806A

D12800

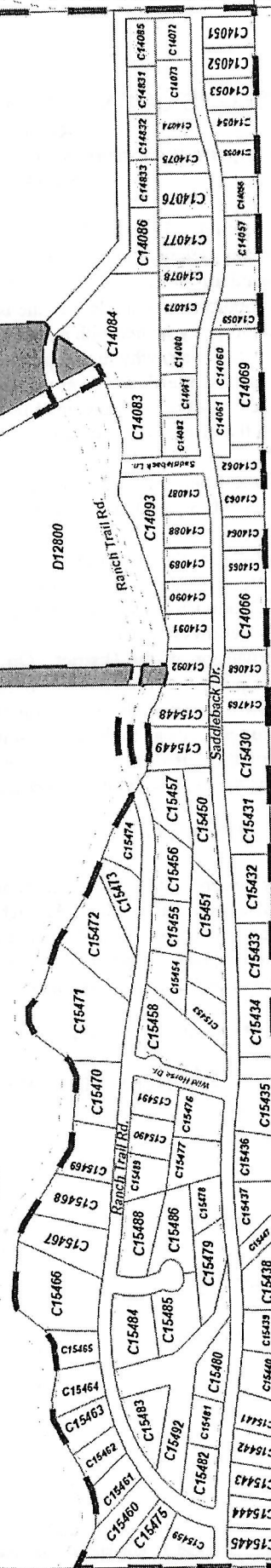

- D02565
- D02566
- C12052
- C12053
- C12054
- C12055
- C12056
- B01947
- B01946
- B02093

Proposed Expansion
 RSID 689m

D02555

D02435

EXHIBIT B
689M SADDLEBACK RIDGE ESTATES - PROPERTY LISTING
FOR 2024 EXPANSION

| Tax ID | Owner_Name | FullAddr | MailAddr1 | City | Zip | Legal Description |
|--------|--|----------------------|----------------------|----------------|---------------|---|
| 1 | C14051 HANSON, BRIAN M | 1910 SADDLEBACK DR | 1910 SADDLEBACK DR | LAUREL | MT 59044-3633 | SADDLEBACK RIDGE ESTATES, S06, T02 S, R24 E, BLOCK 1, Lot 1, 25000 SQUARE FEET |
| 2 | C14052 GOETTLICH, L HAROLD & BRIDGETT J | 1930 SADDLEBACK DR | 1930 SADDLEBACK DR | LAUREL | MT 59044-3633 | SADDLEBACK RIDGE ESTATES, S06, T02 S, R24 E, BLOCK 1, Lot 2, 25499 SQUARE FEET |
| 3 | C14053 CANTRELL, MICHAEL C & JEANNIE M | 1950 SADDLEBACK DR | 1950 SADDLEBACK DR | LAUREL | MT 59044-3633 | SADDLEBACK RIDGE ESTATES, S06, T02 S, R24 E, BLOCK 1, Lot 3, 24946 SQUARE FEET |
| 4 | C14054 CARR, ROBERT H & THERESA P | 1970 SADDLEBACK DR | 1970 SADDLEBACK DR | LAUREL | MT 59044-3633 | SADDLEBACK RIDGE ESTATES, S06, T02 S, R24 E, BLOCK 1, Lot 4, 23307 SQUARE FEET |
| 5 | C14055 MEITZEL, LONNIE | 1990 SADDLEBACK DR | 1990 SADDLEBACK DR | LAUREL | MT 59044-3633 | SADDLEBACK RIDGE ESTATES, S06, T02 S, R24 E, BLOCK 1, Lot 5, 22011 SQUARE FEET |
| 6 | C14056 ABEY, BART W & ABBY M | 2000 SADDLEBACK DR | 2000 SADDLEBACK DR | LAUREL | MT 59044-3634 | SADDLEBACK RIDGE ESTATES, S06, T02 S, R24 E, BLOCK 1, Lot 6, 20269 SQUARE FEET |
| 7 | C14057 STEVENSON, DOUG & SHARON | 2040 SADDLEBACK DR | 2040 SADDLEBACK DR | LAUREL | MT 59044-3634 | SADDLEBACK RIDGE ESTATES, S06, T02 S, R24 E, BLOCK 1, Lot 7, 24349 SQUARE FEET |
| 8 | C14058 CASEY, THOMAS MICHAEL & | 2060 SADDLEBACK DR | 2060 SADDLEBACK DR | LAUREL | MT 59044-3634 | SADDLEBACK RIDGE ESTATES, S06, T02 S, R24 E, BLOCK 1, Lot 8, 22489 SQUARE FEET |
| 9 | C14059 HATVELDT, BRANDON J | 2080 SADDLEBACK DR | 2080 SADDLEBACK DR | LAUREL | MT 59044-3635 | SADDLEBACK RIDGE ESTATES, S06, T02 S, R24 E, BLOCK 1, Lot 9, 20116 SQUARE FEET |
| 10 | C14060 MARK L RUSSELL & JILL M RUSSELL RECOVERABLE | 2100 SADDLEBACK DR | 2100 SADDLEBACK DR | LAUREL | MT 59044-3635 | SADDLEBACK RIDGE ESTATES, S06, T02 S, R24 E, BLOCK 1, Lot 11, 20001 SQUARE FEET |
| 11 | C14061 VON BEHREN, MICHAEL DAVID | 2110 SADDLEBACK DR | 2110 SADDLEBACK DR | LAUREL | MT 59044-3635 | SADDLEBACK RIDGE ESTATES, S06, T02 S, R24 E, BLOCK 1, Lot 12, 23835 SQUARE FEET |
| 12 | C14062 SWANSON, RICHARD LESLIE & LORI ANNETTE | 2130 SADDLEBACK DR | 2130 SADDLEBACK DR | LAUREL | MT 59044-3635 | SADDLEBACK RIDGE ESTATES, S06, T02 S, R24 E, BLOCK 1, Lot 13, 24510 SQUARE FEET |
| 13 | C14063 KIMMETT, PATRICK B | 2150 SADDLEBACK DR | 2150 SADDLEBACK DR | LAUREL | MT 59044-3635 | SADDLEBACK RIDGE ESTATES, S06, T02 S, R24 E, BLOCK 1, Lot 14, 21982 SQUARE FEET |
| 14 | C14064 NARDO, KATHRYN R & NICHOLAS | 2170 SADDLEBACK DR | 2170 SADDLEBACK DR | LAUREL | MT 59044-3635 | SADDLEBACK RIDGE ESTATES, S06, T02 S, R24 E, BLOCK 1, Lot 15, 21980 SQUARE FEET |
| 15 | C14065 KIMMETT, MATTHEW BRYAN & CINDY LOUISE | 2200 SADDLEBACK DR | 2200 SADDLEBACK DR | LAUREL | MT 59044-3636 | SADDLEBACK RIDGE ESTATES, S06, T02 S, R24 E, BLOCK 1, Lot 16 - 17, ACRES 1.008 |
| 16 | C14066 BRIDGER, BERTAN C | 2240 SADDLEBACK DR | 2240 SADDLEBACK DR | LAUREL | MT 59044-3636 | SADDLEBACK RIDGE ESTATES, S06, T02 S, R24 E, BLOCK 1, Lot 18, 21980 SQUARE FEET |
| 17 | C14068 MURPHY, FRANK J & NANCY M | SADDLEBACK DR | PO BOX 220 | LAUREL | MT 59044-0220 | SADDLEBACK RIDGE ESTATES, S06, T02 S, R24 E, BLOCK 1, Lot 19, 1.367 ac (03) |
| 18 | C14069 SADDLEBACK RIDGE HOMEOWNERS ASSOCIATION INC | 1915 SADDLEBACK DR | 1915 SADDLEBACK DR | LAUREL | MT 59044-3629 | SADDLEBACK RIDGE ESTATES, S06, T02 S, R24 E, BLOCK 2, Lot 1, (OLD CODE D02554) 20100 SF (03) |
| 19 | C14072 NOBLE, JAMES I & NATALIE | 1935 SADDLEBACK DR | 1935 SADDLEBACK DR | LAUREL | MT 59044-3629 | SADDLEBACK RIDGE ESTATES, S06, T02 S, R24 E, BLOCK 2, Lot 2 |
| 20 | C14073 MCKITTRICK, GORDON & TONI | 1965 SADDLEBACK DR | 1965 SADDLEBACK DR | LAUREL | MT 59044-3629 | SADDLEBACK RIDGE ESTATES, S06, T02 S, R24 E, BLOCK 2, Lot 3 |
| 21 | C14074 UNDERWOOD, KAREN J | 1985 SADDLEBACK DR | 1985 SADDLEBACK DR | LAUREL | MT 59044-3629 | SADDLEBACK RIDGE ESTATES, S06, T02 S, R24 E, BLOCK 2, Lot 4 |
| 22 | C14075 NAILLON, CODY J & | 1995 SADDLEBACK DR | 1995 SADDLEBACK DR | LAUREL | MT 59044-3637 | SADDLEBACK RIDGE ESTATES, S06, T02 S, R24 E, BLOCK 2, Lot 5 |
| 23 | C14076 PETERS, BRENT S & BETTY R | 2025 SADDLEBACK DR | 2025 SADDLEBACK DR | LAUREL | MT 59044-3637 | SADDLEBACK RIDGE ESTATES, S06, T02 S, R24 E, BLOCK 2, Lot 6 |
| 24 | C14077 FIGHTNER, KENNETH W & KATHY J | 2075 SADDLEBACK DR | 2075 SADDLEBACK DR | LAUREL | MT 59044-3637 | SADDLEBACK RIDGE ESTATES, S06, T02 S, R24 E, BLOCK 2, Lot 7 |
| 25 | C14078 HARMON, JEFFREY S & ONDRIA | 2095 SADDLEBACK DR | 2095 SADDLEBACK DR | LAUREL | MT 59044-3637 | SADDLEBACK RIDGE ESTATES, S06, T02 S, R24 E, BLOCK 2, Lot 8 |
| 26 | C14079 DAVIS, ANDREW B & SARAH | 2105 SADDLEBACK DR | 2105 SADDLEBACK DR | LAUREL | MT 59044-3630 | SADDLEBACK RIDGE ESTATES, S06, T02 S, R24 E, BLOCK 2, Lot 9 |
| 27 | C14080 DENNETT, JOEL & HANNAH | 2175 SADDLEBACK DR | 2175 SADDLEBACK DR | LAUREL | MT 59044-3630 | SADDLEBACK RIDGE ESTATES, S06, T02 S, R24 E, BLOCK 2, Lot 10 |
| 28 | C14081 ZAKRZEWSKI, JOHN W & HEIDI L | 2195 SADDLEBACK DR | 2195 SADDLEBACK DR | LAUREL | MT 59044-3630 | SADDLEBACK RIDGE ESTATES, S06, T02 S, R24 E, BLOCK 2, Lot 11 |
| 29 | C14082 WEIG, ZACHARY G & NATALIE R | 2105 SADDLEBACK DR | 2105 SADDLEBACK DR | LAUREL | MT 59044-1652 | SADDLEBACK RIDGE ESTATES, S06, T02 S, R24 E, BLOCK 2, Lot 12 |
| 30 | C14083 WOOD, BRYAN E & LOU ANN | 1295 SADDLEBACK LANE | 1295 SADDLEBACK LANE | LAUREL | MT 59044-3611 | SADDLEBACK RIDGE ESTATES, S06, T02 S, R24 E, BLOCK 2, Lot 13 |
| 31 | C14084 DUKE, KYLE NATHAN & ALESHA SUE | 2050 RANCH TRAIL RD | 2050 RANCH TRAIL RD | LAUREL | MT 59044-3626 | SADDLEBACK RIDGE ESTATES, S06, T02 S, R24 E, BLOCK 2, Lot 14A, EST AMD (21780 SQ FT) (05) |
| 32 | C14085 SHOVAR, JUSTIN | 1900 RANCH TRAIL RD | 1900 RANCH TRAIL RD | LAUREL | MT 59044-3626 | SADDLEBACK RIDGE ESTATES, S06, T02 S, R24 E, BLOCK 2, Lot 15A, EST AMD 34180 SQ FT (05) |
| 33 | C14086 SADDLEBACK RIDGE HOMEOWNERS ASSOCIATION INC | 2000 RANCH TRAIL RD | PO BOX 220 | LAUREL | MT 59044-0220 | SADDLEBACK RIDGE ESTATES, S06, T02 S, R24 E, BLOCK 2, Lot 1, 24336 SQUARE FEET |
| 34 | C14087 ECHO-HAWK, JOSEPH & ANGELA | 2125 SADDLEBACK DR | 2125 SADDLEBACK DR | LAUREL | MT 59044-3631 | SADDLEBACK RIDGE ESTATES, S06, T02 S, R24 E, BLOCK 3, Lot 1, 21540 SQUARE FEET |
| 35 | C14088 ARNOLD, EUGENE C & SHERRY L | 2155 SADDLEBACK DR | 2155 SADDLEBACK DR | LAUREL | MT 59044-3631 | SADDLEBACK RIDGE ESTATES, S06, T02 S, R24 E, BLOCK 3, Lot 3, 21553 SQUARE FEET |
| 36 | C14089 MCKENZIE, MARGARET A | 2165 SADDLEBACK DR | 2165 SADDLEBACK DR | LAUREL | MT 59044-3631 | SADDLEBACK RIDGE ESTATES, S06, T02 S, R24 E, BLOCK 3, Lot 4, 21156 SQUARE FEET |
| 37 | C14090 EWALT, R KENT & MAILE J | 2175 SADDLEBACK DR | 2175 SADDLEBACK DR | LAUREL | MT 59044-3632 | SADDLEBACK RIDGE ESTATES, S06, T02 S, R24 E, BLOCK 3, Lot 5, 22503 SQUARE FEET |
| 38 | C14091 FILLNER FAMILY TRUST | 2215 SADDLEBACK DR | 2215 SADDLEBACK DR | LAUREL | MT 59044-3627 | SADDLEBACK RIDGE ESTATES, S06, T02 S, R24 E, BLOCK 3, Lot 6, 21730 SQUARE FEET |
| 39 | C14092 MCGOVERN, KEVIN K & SANDRA K | 2235 SADDLEBACK DR | 2235 SADDLEBACK DR | LAUREL | MT 59044-3636 | SADDLEBACK RIDGE ESTATES SUB 2ND FIL, S06, T02 S, R24 E, BLOCK 3, Lot 7, ACRES 1.151 |
| 40 | C14093 BROYLES, MARK & JAMI | 1290 SADDLEBACK LN | 1290 SADDLEBACK LN | LAUREL | MT 59044-0490 | SADDLEBACK RIDGE ESTATES SUB 2ND FIL, S06, T02 S, R24 E, BLOCK 1, Lot 19, ACRES 0.547 |
| 41 | C14769 MULLET, WCV & BRENDAN J | 2260 SADDLEBACK DR | 2260 SADDLEBACK DR | LAUREL | MT 59044-3626 | SADDLEBACK RIDGE ESTATES SUB 2ND FIL, S06, T02 S, R24 E, BLOCK 2, Lot 14B, EST AMD (21780 SQ FT) (05) |
| 42 | C14831 SMARSH, DONALD W | 1940 RANCH TRAIL RD | 1940 RANCH TRAIL RD | LAUREL | MT 59044-3626 | SADDLEBACK RIDGE ESTATES SUB 2ND FIL, S06, T02 S, R24 E, BLOCK 1, Lot 21, ACRES 0.904 |
| 43 | C14832 KLEBE, KRISTEN J & JUSTIN A | 1960 RANCH TRAIL RD | 1960 RANCH TRAIL RD | LAUREL | MT 59044-3611 | SADDLEBACK RIDGE ESTATES SUB 2ND FIL, S06, T02 S, R24 E, BLOCK 1, Lot 22, ACRES 0.855 |
| 44 | C14833 HARPER, TIMOTHY L & LYNN S | 1980 RANCH TRAIL RD | 1980 RANCH TRAIL RD | LAUREL | MT 59044-3624 | SADDLEBACK RIDGE ESTATES SUB 2ND FIL, S06, T02 S, R24 E, BLOCK 1, Lot 23, ACRES 0.748 |
| 45 | C15430 FAUTH, JULIE A & MIKE L | 2280 SADDLEBACK DR | 2280 SADDLEBACK DR | LAUREL | MT 59044-3624 | SADDLEBACK RIDGE ESTATES SUB 2ND FIL, S06, T02 S, R24 E, BLOCK 1, Lot 24, ACRES 0.74 |
| 46 | C15431 WEBER, RONALD D | 2310 SADDLEBACK DR | PO BOX 490 | LAUREL | MT 59044-3636 | SADDLEBACK RIDGE ESTATES SUB 2ND FIL, S06, T02 S, R24 E, BLOCK 1, Lot 25, ACRES 0.657 |
| 47 | C15432 TORNA, STEPHEN & JERRI DAWN | 2340 SADDLEBACK DR | 2340 SADDLEBACK DR | LAUREL | MT 59044-0490 | SADDLEBACK RIDGE ESTATES SUB 2ND FIL, S06, T02 S, R24 E, BLOCK 1, Lot 26, ACRES 0.657 |
| 48 | C15433 DETIENNE, NIKOLAS R AMY L | 2370 SADDLEBACK DR | 2370 SADDLEBACK DR | LAUREL | MT 59044-3623 | SADDLEBACK RIDGE ESTATES SUB 2ND FIL, S06, T02 S, R24 E, BLOCK 1, Lot 27, ACRES 0.657 |
| 49 | C15434 ROBERTS, LARRY L & DEBRA A | 2400 SADDLEBACK DR | 2400 SADDLEBACK DR | LAUREL | MT 59044-3624 | SADDLEBACK RIDGE ESTATES SUB 2ND FIL, S06, T02 S, R24 E, BLOCK 1, Lot 28, ACRES 0.606 |
| 50 | C15435 GRAY, MICHAEL D & LISA | 2430 SADDLEBACK DR | 2430 SADDLEBACK DR | LAUREL | MT 59044-3624 | SADDLEBACK RIDGE ESTATES SUB 2ND FIL, S06, T02 S, R24 E, BLOCK 1, Lot 29, ACRES 0.471 |
| 51 | C15436 KAREN L KENNAH LIVING TRUST | 2460 SADDLEBACK DR | 2460 SADDLEBACK DR | LAUREL | MT 59044-3624 | SADDLEBACK RIDGE ESTATES SUB 2ND FIL, S06, T02 S, R24 E, BLOCK 1, Lot 25, ACRES 0.657 |
| 52 | C15437 VANLAARHOVEN, KEVIN & RUTH | 2490 SADDLEBACK DR | 2490 SADDLEBACK DR | LAUREL | MT 59044-3624 | SADDLEBACK RIDGE ESTATES SUB 2ND FIL, S06, T02 S, R24 E, BLOCK 1, Lot 26, ACRES 0.657 |
| 53 | C15438 DARPINO, GLORIA | 2520 SADDLEBACK DR | 2520 SADDLEBACK DR | LAUREL | MT 59044-3625 | SADDLEBACK RIDGE ESTATES SUB 2ND FIL, S06, T02 S, R24 E, BLOCK 1, Lot 27, ACRES 0.657 |
| 54 | C15439 PETERSON, VERNON L & GERALDINE A | 2550 SADDLEBACK DR | 17106 1111TH STE | BONNEY LAKE WA | 98331-5174 | SADDLEBACK RIDGE ESTATES SUB 2ND FIL, S06, T02 S, R24 E, BLOCK 1, Lot 29, ACRES 0.471 |

EXHIBIT B
689M SADDLEBACK RIDGE ESTATES - PROPERTY LISTING
FOR 2024 EXPANSION

| | | | | | | | |
|-----|--------|--|---------------------|----------|----|------------|---|
| 55 | C15440 | O'CONNELL, TIMOTHY PATRICK & NAOMI ANITA | 2580 SADDLEBACK DR | LAUREL | MT | 59044-3625 | SADDLEBACK RIDGE ESTATES SUB 2ND FIL, S06, T02 S, R24 E, BLOCK 1, Lot 30, ACRES 0.55 |
| 56 | C15441 | ALDERFER REVOCABLE TRUST | 2600 SADDLEBACK DR | LAUREL | MT | 59044-3628 | SADDLEBACK RIDGE ESTATES SUB 2ND FIL, S06, T02 S, R24 E, BLOCK 1, Lot 31, ACRES 0.534 |
| 57 | C15442 | LYNCH, JOSEPH P & EMILY A | 2620 SADDLEBACK DR | LAUREL | MT | 59044-3638 | SADDLEBACK RIDGE ESTATES SUB 2ND FIL, S06, T02 S, R24 E, BLOCK 1, Lot 32, ACRES 0.534 |
| 58 | C15443 | DURAND, MITCHELL J & JANEALE R | 2640 SADDLEBACK DR | LAUREL | MT | 59044-3638 | SADDLEBACK RIDGE ESTATES SUB 2ND FIL, S06, T02 S, R24 E, BLOCK 1, Lot 33, ACRES 0.534 |
| 59 | C15444 | GOLDEN, ANTHONY J & CASEY | 1008 PHIL CIR | LAUREL | MT | 59044-3327 | SADDLEBACK RIDGE ESTATES SUB 2ND FIL, S06, T02 S, R24 E, BLOCK 1, Lot 34, ACRES 0.534 |
| 60 | C15445 | KAUTZ, DOUGLAS H & JULIE A | 2680 SADDLEBACK DR | LAUREL | MT | 59044-3638 | SADDLEBACK RIDGE ESTATES SUB 2ND FIL, S06, T02 S, R24 E, BLOCK 3, Lot 8, ACRES 0.807 |
| 61 | C15448 | KNECHT, PHILLIP & JODI | 2255 SADDLEBACK DR | LAUREL | MT | 59044-3632 | SADDLEBACK RIDGE ESTATES SUB 2ND FIL, S06, T02 S, R24 E, BLOCK 3, Lot 9, ACRES 0.918 |
| 62 | C15449 | PITTAKE, MICHELLE | 2275 SADDLEBACK DR | LAUREL | MT | 59044-3632 | SADDLEBACK RIDGE ESTATES SUB 2ND FIL, S06, T02 S, R24 E, BLOCK 3, Lot 10, ACRES 0.927 |
| 63 | C15450 | FLOHR, GARY D & KAREN R | 2315 SADDLEBACK DR | LAUREL | MT | 59044-3623 | SADDLEBACK RIDGE ESTATES SUB 2ND FIL, S06, T02 S, R24 E, BLOCK 3, Lot 11A, AMD (16) |
| 64 | C15451 | FOUST FAMILY TRUST | 2355 SADDLEBACK DR | LAUREL | MT | 59044-3623 | SADDLEBACK RIDGE ESTATES SUB 2ND FIL, S06, T02 S, R24 E, BLOCK 3, Lot 12A, AMD (16) |
| 65 | C15452 | HARVEY AND MERRYLEEN PETERSON FAMILY REVOCABLE T | 2385 SADDLEBACK DR | LAUREL | MT | 59044-3623 | SADDLEBACK RIDGE ESTATES SUB 2ND FIL, S06, T02 S, R24 E, BLOCK 3, Lot 13, ACRES 0.621 |
| 66 | C15453 | DAWSON, KYLE C TRUSTEE & | 2405 SADDLEBACK DR | LAUREL | MT | 59044-3624 | SADDLEBACK RIDGE ESTATES SUB 2ND FIL, S06, T02 S, R24 E, BLOCK 3, Lot 14, ACRES 0.656 |
| 67 | C15454 | JARES, JUSTIN L & JONI M | 2390 RANCH TRAIL RD | LAUREL | MT | 59044-3641 | SADDLEBACK RIDGE ESTATES SUB 2ND FIL, S06, T02 S, R24 E, BLOCK 3, Lot 15, ACRES 0.704 |
| 68 | C15455 | HARMALA, JEREMY & AMY | 2360 RANCH TRAIL RD | LAUREL | MT | 59044-3641 | SADDLEBACK RIDGE ESTATES SUB 2ND FIL, S06, T02 S, R24 E, BLOCK 3, Lot 16, ACRES 0.877 |
| 69 | C15456 | WHITMOYER, COLE & KATIE | 2330 RANCH TRAIL RD | LAUREL | MT | 59044-3641 | SADDLEBACK RIDGE ESTATES SUB 2ND FIL, S06, T02 S, R24 E, BLOCK 3, Lot 17, ACRES 0.894 |
| 70 | C15457 | MAURER, THOMAS E & JACKIE S | 2300 RANCH TRAIL RD | LAUREL | MT | 59107-5000 | SADDLEBACK RIDGE ESTATES SUB 2ND FIL, S06, T02 S, R24 E, BLOCK 3, Lot PARK, 1.610 AC |
| 71 | C15458 | YELLOWSTONE COUNTY | PO BOX 35000 | BILLINGS | MT | 59044-3645 | SADDLEBACK RIDGE ESTATES SUB 2ND FIL, S06, T02 S, R24 E, BLOCK 4, Lot 1, ACRES 0.635 |
| 72 | C15459 | WISE, JASON & SARAH | 2715 RANCH TRAIL RD | LAUREL | MT | 59044-3645 | SADDLEBACK RIDGE ESTATES SUB 2ND FIL, S06, T02 S, R24 E, BLOCK 4, Lot 2, ACRES 0.921 |
| 73 | C15460 | MAACK, THOMAS G JR & KAMIL | 2685 RANCH TRAIL RD | LAUREL | MT | 59044-3611 | SADDLEBACK RIDGE ESTATES SUB 2ND FIL, S06, T02 S, R24 E, BLOCK 4, Lot 3, ACRES 0.596 |
| 74 | C15461 | BACK NINE RETREAT TRUST | 2665 RANCH TRAIL RD | MESQUITE | NV | 89027-8844 | SADDLEBACK RIDGE ESTATES SUB 2ND FIL, S06, T02 S, R24 E, BLOCK 4, Lot 4, ACRES 0.594 |
| 75 | C15462 | OLSEN, THORSAN & KARA | 2645 RANCH TRAIL RD | LAUREL | MT | 59044-3644 | SADDLEBACK RIDGE ESTATES SUB 2ND FIL, S06, T02 S, R24 E, BLOCK 4, Lot 6, ACRES 0.726 |
| 76 | C15463 | MARTIN, TIMOTHY J & DANIELLE R | 2625 RANCH TRAIL RD | LAUREL | MT | 59044-3644 | SADDLEBACK RIDGE ESTATES SUB 2ND FIL, S06, T02 S, R24 E, BLOCK 4, Lot 7, ACRES 0.572 |
| 77 | C15464 | KINDT, GREGORY S & GWENDOLYN A | 2605 RANCH TRAIL RD | LAUREL | MT | 59044-3643 | SADDLEBACK RIDGE ESTATES SUB 2ND FIL, S06, T02 S, R24 E, BLOCK 4, Lot 8, ACRES 1.231 |
| 78 | C15465 | MAREK, DENNY R & MARY KAREN | 2585 RANCH TRAIL RD | LAUREL | MT | 59044-3643 | SADDLEBACK RIDGE ESTATES SUB 2ND FIL, S06, T02 S, R24 E, BLOCK 4, Lot 10, ACRES 1.105 |
| 79 | C15466 | DAVIDSON, DEVON R & KIMBERLY K | 2565 RANCH TRAIL RD | LAUREL | MT | 59044-3643 | SADDLEBACK RIDGE ESTATES SUB 2ND FIL, S06, T02 S, R24 E, BLOCK 4, Lot 11, ACRES 0.933 |
| 80 | C15467 | KETCHUM, SAMUEL J & GAIL A | 2545 RANCH TRAIL RD | LAUREL | MT | 59044-3642 | SADDLEBACK RIDGE ESTATES SUB 2ND FIL, S06, T02 S, R24 E, BLOCK 4, Lot 12, ACRES 0.996 |
| 81 | C15468 | BARTHEL, ROBERT P & ROSALIE D | 2515 RANCH TRAIL RD | LAUREL | MT | 59044-3642 | SADDLEBACK RIDGE ESTATES SUB 2ND FIL, S06, T02 S, R24 E, BLOCK 4, Lot 13, ACRES 2.789 |
| 82 | C15469 | TRUST AGREEMENT | 2485 RANCH TRAIL RD | LAUREL | MT | 59044-3642 | SADDLEBACK RIDGE ESTATES SUB 2ND FIL, S06, T02 S, R24 E, BLOCK 4, Lot 14, ACRES 1.731 |
| 83 | C15470 | FRANK, PHILIP D JR & TAMARA R | 2455 RANCH TRAIL RD | LAUREL | MT | 59044-3641 | SADDLEBACK RIDGE ESTATES SUB 2ND FIL, S06, T02 S, R24 E, BLOCK 4, Lot 15A, 2ND FIL AMD (10) |
| 84 | C15471 | PIERCE, SALLY A & BLAKE A | 2435 RANCH TRAIL RD | LAUREL | MT | 59044-3641 | SADDLEBACK RIDGE ESTATES SUB 2ND FIL, S06, T02 S, R24 E, BLOCK 4, Lot 16A, 2ND FIL AMD (10) |
| 85 | C15472 | BURTON, LUKE & TERRI | 2395 RANCH TRAIL RD | LAUREL | MT | 59044-3644 | SADDLEBACK RIDGE ESTATES SUB 2ND FIL, S06, T02 S, R24 E, BLOCK 5, Lot 1, ACRES 0.759 |
| 86 | C15473 | DICK L OSTERMILLER LIVING TRUST | 2355 RANCH TRAIL RD | LAUREL | MT | 59044-3624 | SADDLEBACK RIDGE ESTATES SUB 2ND FIL, S06, T02 S, R24 E, BLOCK 5, Lot 2, ACRES 0.784 |
| 87 | C15474 | DONNA LYNN WILSON REVOCABLE LIVING TRUST | 2305 RANCH TRAIL RD | LAUREL | MT | 59044-3624 | SADDLEBACK RIDGE ESTATES SUB 2ND FIL, S06, T02 S, R24 E, BLOCK 5, Lot 3, ACRES 0.52 |
| 88 | C15476 | NORMAN, JESSE T & JENNIFER M | 2445 SADDLEBACK DR | LAUREL | MT | 59044-3624 | SADDLEBACK RIDGE ESTATES SUB 2ND FIL, S06, T02 S, R24 E, BLOCK 5, Lot 4, ACRES 0.836 |
| 89 | C15477 | CORTEZ, ASHLEY GRIFFITH | 2465 SADDLEBACK DR | LAUREL | MT | 59044-3624 | SADDLEBACK RIDGE ESTATES SUB 2ND FIL, S06, T02 S, R24 E, BLOCK 5, Lot 5, ACRES 0.877 |
| 90 | C15478 | HOLDEN, ERIC A & TRINITY J | 2485 SADDLEBACK DR | LAUREL | MT | 59044-3625 | SADDLEBACK RIDGE ESTATES SUB 2ND FIL, S06, T02 S, R24 E, BLOCK 5, Lot 6, ACRES 0.532 |
| 91 | C15479 | TSCHACHER, BARTHOLEMEW M & HEIDI K | 1285 SADDLEBACK DR | LAUREL | MT | 59044-3638 | SADDLEBACK RIDGE ESTATES SUB 2ND FIL, S06, T02 S, R24 E, BLOCK 5, Lot 7, ACRES 0.667 |
| 92 | C15480 | GOODSON, MARK & TIFFANY | 2575 SADDLEBACK DR | LAUREL | MT | 59044-3638 | SADDLEBACK RIDGE ESTATES SUB 2ND FIL, S06, T02 S, R24 E, BLOCK 5, Lot 8, ACRES 0.823 |
| 93 | C15481 | HURTIG, ROBERT & CAROLE J | 2615 SADDLEBACK DR | LAUREL | MT | 59044-3644 | SADDLEBACK RIDGE ESTATES SUB 2ND FIL, S06, T02 S, R24 E, BLOCK 5, Lot 9, ACRES 1.062 |
| 94 | C15482 | BOHNET, THOMAS S & MARY LOU | 2645 SADDLEBACK DR | LAUREL | MT | 59044-3644 | SADDLEBACK RIDGE ESTATES SUB 2ND FIL, S06, T02 S, R24 E, BLOCK 5, Lot 10, ACRES 0.967 |
| 95 | C15483 | BURTELL, ELAINE J & DANIEL | 2650 RANCH TRAIL RD | LAUREL | MT | 59044-3639 | SADDLEBACK RIDGE ESTATES SUB 2ND FIL, S06, T02 S, R24 E, BLOCK 5, Lot 11A, 2ND FIL AMD |
| 96 | C15484 | TROSTLE, KEVIN & PAMELA | 1310 SADDLEHORN DR | LAUREL | MT | 59044-3643 | SADDLEBACK RIDGE ESTATES SUB 2ND FIL, S06, T02 S, R24 E, BLOCK 5, Lot 13A, 13A BLK 5 SADDLEBACK RIDGE EST 2ND FIL AMD |
| 97 | C15485 | PLUMB, ROSEMARIE & RONNIE J & | 1290 SADDLEHORN DR | LAUREL | MT | 59044-3643 | SADDLEBACK RIDGE ESTATES SUB 2ND FIL, S06, T02 S, R24 E, BLOCK 5, Lot 13A, 13A BLK 5 SADDLEBACK RIDGE EST 2ND FIL AMD |
| 98 | C15486 | TSCHACHER, BARTHOLEMEW M & HEIDI K | 1285 SADDLEHORN DR | LAUREL | MT | 59044-3643 | SADDLEBACK RIDGE ESTATES SUB 2ND FIL, S06, T02 S, R24 E, BLOCK 5, Lot 13A, 13A BLK 5 SADDLEBACK RIDGE EST 2ND FIL AMD |
| 99 | C15488 | HENRY, STEVEN R & JUDY KAY | 2540 RANCH TRAIL RD | LAUREL | MT | 59044-3642 | SADDLEBACK RIDGE ESTATES SUB 2ND FIL, S06, T02 S, R24 E, BLOCK 5, Lot 14, ACRES 0.589 |
| 100 | C15489 | STEPPE, JUSTIN L & CHRISTINA M | 2490 RANCH TRAIL RD | LAUREL | CA | 90713-3332 | SADDLEBACK RIDGE ESTATES SUB 2ND FIL, S06, T02 S, R24 E, BLOCK 5, Lot 15, ACRES 0.599 |
| 101 | C15490 | ANDERSON, DEBORAH J & STEVEN A | 4243 REDLINE DR | LAKEWOOD | MT | 59044-3655 | SADDLEBACK RIDGE ESTATES SUB 2ND FIL, S06, T02 S, R24 E, BLOCK 5, Lot 16, ACRES 0.587 |
| 102 | C15491 | JAMES G BELL TRUST | 1310 WILD HORSE RD | LAUREL | MT | 59044 506 | T02 S, R24 E, C.O.S. 3471, PARCEL 3, (12) |
| 103 | D12800 | VENTLING, MARK L & HEIDI K | 2070 RANCH TRAIL RD | LAUREL | MT | 59044 506 | T02 S, R24 E, C.O.S. 3471, PARCEL 3, (12) |
| 104 | D12801 | KERNS FAMILY REVOCABLE LIVING TRUST | 1410 GOLF COURSE RD | LAUREL | MT | 59044-3600 | 506, T02 S, R24 E, C.O.S. 3099, PARCEL 1B1, AMD TR 1A & 1B (17) |

Parcels to Include in expansion:

| | | | | | | | |
|-----|---------|-------------------|---------------------|--------|----|------------|--|
| 105 | D12806 | TRUST AGREEMENT | 2485 RANCH TRAIL RD | LAUREL | MT | 59044-3642 | 506, T02 S, R24 E, C.O.S. 3471, PARCEL 1A, AMD TR 1 & 2 (17) |
| 106 | D12806A | VENTLING, KADEN & | 2255 RANCH TRAIL RD | LAUREL | MT | 59044 506 | T02 S, R24 E, C.O.S. 3471, PARCEL 2A2, AMD (24) |

EXHIBIT B
689M SADDLEBACK RIDGE ESTATES - PROPERTY LISTING
FOR 2024 EXPANSION

PARK PARCELS:

| | | | | | | | |
|--------|--------------------|---------------|--------------|----------|----|------------|---|
| C15446 | YELLOWSTONE COUNTY | SADDLEBACK DR | PO BOX 35000 | BILLINGS | MT | 59107-5000 | SADDLEBACK RIDGE ESTATES SUB 2ND FIL, S06, T02 S, R24 E, BLOCK 1, Lot PARK, BETWEEN LTS 24 & 25 .234 AC |
| C15447 | YELLOWSTONE COUNTY | SADDLEBACK DR | PO BOX 35000 | BILLINGS | MT | 59107-5000 | SADDLEBACK RIDGE ESTATES SUB 2ND FIL, S06, T02 S, R24 E, BLOCK 1, Lot PARK, BETWEEN LTS 27 & 28 .318 AC |
| C15475 | YELLOWSTONE COUNTY | SADDLEBACK DR | PO BOX 35000 | BILLINGS | MT | 59107-5000 | SADDLEBACK RIDGE ESTATES SUB 2ND FIL, S06, T02 S, R24 E, BLOCK 4, Lot PARK, .623 AC (07) |
| C15492 | YELLOWSTONE COUNTY | SADDLEBACK DR | PO BOX 35000 | BILLINGS | MT | 59107-5000 | SADDLEBACK RIDGE ESTATES SUB 2ND FIL, S06, T02 S, R24 E, BLOCK 5, Lot PARK, 2.277 AC (07) |

